

# PRODUCT INFORMATION PACKET

Model No: 056T34F99031  
Catalog No: KG236A  
1 1/2,3600,TEFC,56J,3/60/230/460  
Jet Pump

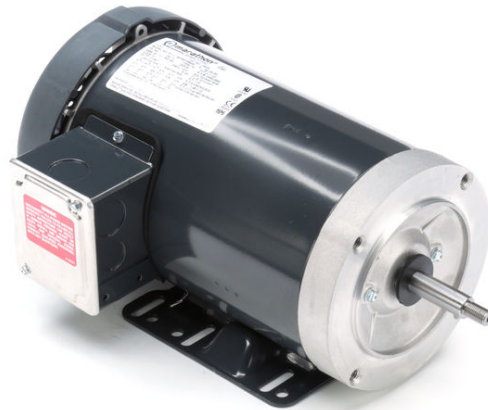

Regal and Marathon are trademarks of Regal Beloit Corporation or one of its affiliated companies.  
©2018 Regal Beloit Corporation, All Rights Reserved. MC017097E



### Nameplate Specifications

Output HP	<b>1.50 Hp</b>	Output KW	<b>1.1 kW</b>
Frequency	<b>60 Hz</b>	Voltage	<b>230/460 V</b>
Current	<b>4.0/2.0 A</b>	Speed	<b>3450 rpm</b>
Service Factor	<b>1.3</b>	Phase	<b>3</b>
Efficiency	<b>84 %</b>	Duty	<b>Continuous</b>
Insulation Class	<b>B</b>	Design Code	<b>B</b>
KVA Code	<b>M</b>	Frame	<b>56J</b>
Enclosure	<b>Totally Enclosed Fan Cooled</b>	Overload Protector	<b>No</b>
Ambient Temperature	<b>40 °C</b>	Drive End Bearing Size	<b>6205</b>
Opp Drive End Bearing Size	<b>6203</b>	UL	<b>Recognized</b>
CSA	<b>Y</b>	CE	<b>Y</b>
IP Code	<b>43</b>		

### Technical Specifications

Electrical Type	<b>Squirrel Cage Induction Run</b>	Starting Method	<b>Across The Line</b>
Poles	<b>2</b>	Rotation	<b>Reversible</b>
Mounting	<b>Round</b>	Motor Orientation	<b>HORIZONTAL</b>
Drive End Bearing	<b>BALL</b>	Opp Drive End Bearing	<b>BALL</b>
Frame Material	<b>Rolled Steel</b>	Shaft Type	<b>J</b>
Overall Length	<b>13.82 in</b>	Frame Length	<b>8.06 in</b>
Shaft Diameter	<b>0.625 in</b>	Shaft Extension	<b>2.57 in</b>
Assembly/Box Mounting	<b>F1 ONLY</b>		
Outline Drawing	<b>A-100352-806</b>	Connection Diagram	<b>EE7308</b>

This is an uncontrolled document once printed or downloaded and is subject to change without notice. Date Created: 10/30/2018

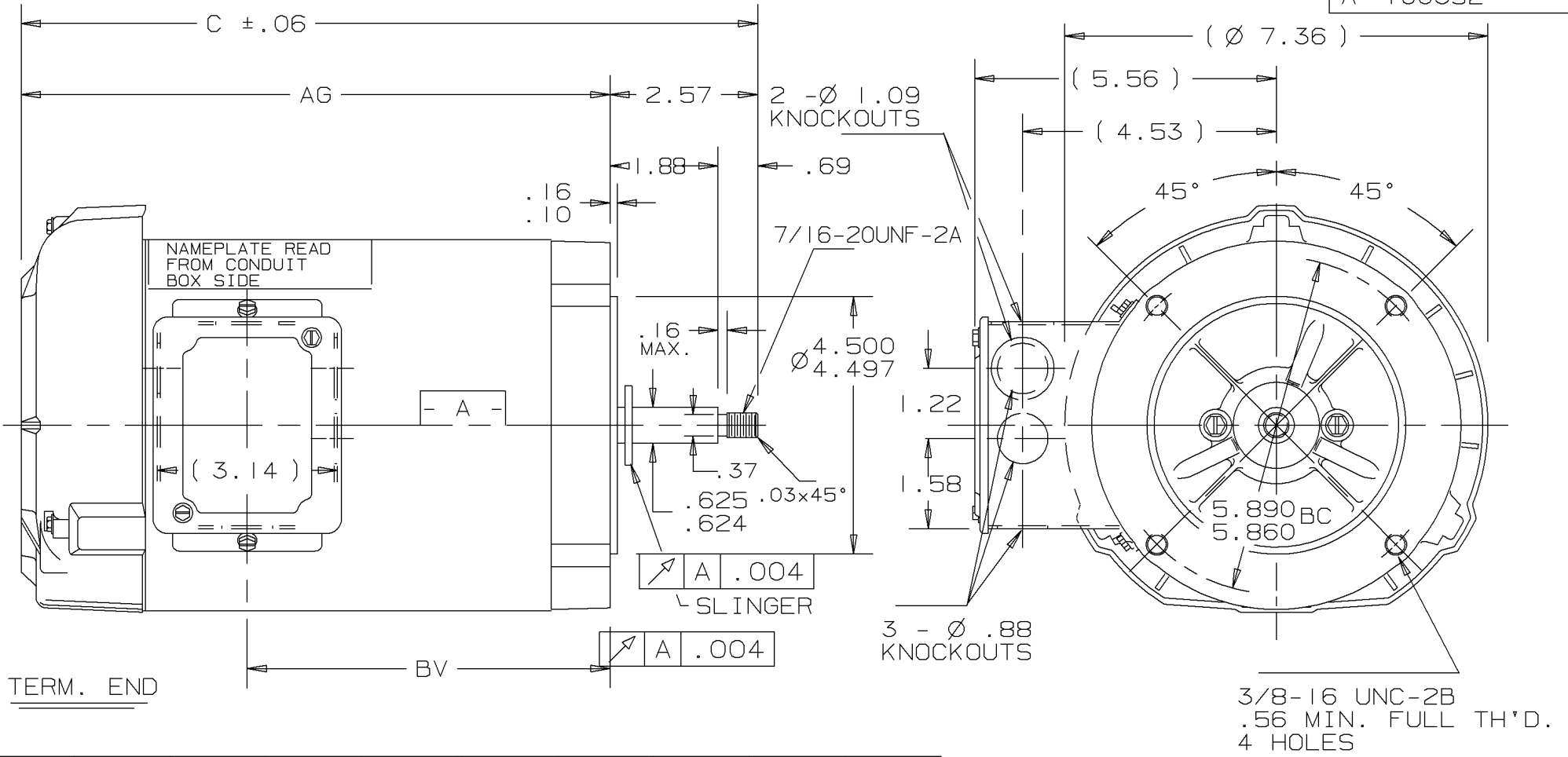

DASH	FR.	C	AG	BV	DASH	FR.	C	AG	BV
606	56-60	11.82	9.25	5.31	806	56-80	13.82	11.25	7.31
656	"-65	12.32	9.75	5.81	856	"-85	14.32	11.75	7.81
706	"-70	12.82	10.25	6.31	906	"-90	14.82	12.25	8.31
756	"-75	13.32	10.75	6.81	956	"-95	15.32	12.75	8.81

NOTES:  
CONDUIT BOX CAN BE ROTATED 180°

				125 $\sqrt{\text{SURFACE ROUGHNESS UNLESS NOTED OTHERWISE}}$		UNLESS OTHERWISE SPECIFIED DIMENSIONS ARE IN INCHES TOL ON XX± .03 XXX±.005 XXXX±.0005 ANGLES± 1°			
				MATL SPEC		NEMA JET PUMP		DRAWN BY GK 10-2-89	
2		3-20-90		REISSUE SLINGER ADDED		GK		CHKD BY	
1		10-2-89		NEW DRAWING		GK		APPD BY	
REV		DATE		CHANGE		NAME		DRWG NO A- 100352	

EE7308

THREE PHASE  
DUAL VOLTAGE MOTOR

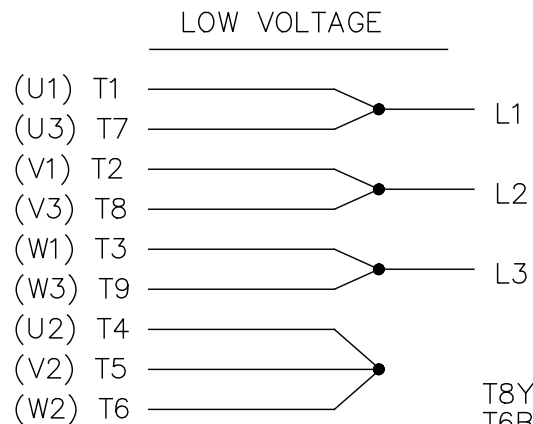
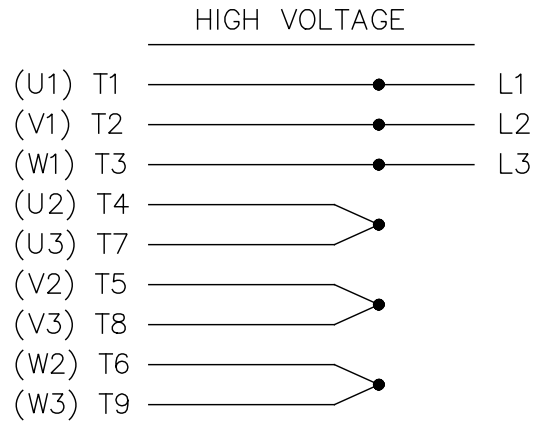

VIEW OF TERMINAL END

REF.  
WINDING DIAGRAM

T8Y, T2Y, T2BL, T4BX, T2EC, T2G  
T6BZ, T2B, T6BL, T4AV, T6B, T4B

OPTIONAL CORD  
CONNECTION

L1 — WHITE  
L2 — RED  
L3 — BLACK

NO.	REVISION	BY & DATE	CHK	ANG	TOLERANCES UNLESS SPECIFIED		FINISH	DRAWN RM 11/20/1990				
					DEC.	INCHES						
5	CHG TO REGAL LOGO	SL 09/10/2015	AB					CHK ML 11/21/1990				
4	REVISED IEC NOTATIONS	MSG 11/15/2011	CMN	.X	±.1			APPD SAS 04/24/2003				
3	ADDED IEC NOTATIONS... (U1), (V1) ETC. MU95194	MSG 5/10/2010	MJS	.XX	±.02			SCALE 1=1				
2	ADDED THE OPTIONAL CORD CONNECTION MU46318	RDH 04/24/2003	DRS	.XXX	±.005		TITLE CONNECTION DIAGRAM 3Ø - DUAL VOLTAGE MOTOR	REF				
1	REDRAWN	RM 11/20/1990		.XXXX	±.0005		MAT'L.	FMF				
					±7'30"			PREV				
THIS DRAWING IN DESIGN AND DETAIL IS OUR PROPERTY AND MUST NOT BE USED EXCEPT IN CONNECTION WITH OUR WORK ALL RIGHTS OF DESIGN AND INVENTION ARE RESERVED THIS IS AN ELECTRONICALLY GENERATED DOCUMENT - DO NOT SCALE THIS PRINT							RFP	CAD FILE ee7308	SIZE A	DRAWING NO. EE7308	PAGE OF 5	REV. 5
							DIST WP					



Regal Beloit America, Inc.

3Ø - DUAL VOLTAGE MOTOR

ee7308

EE7308

5



P.O. BOX 8003  
WAUSAU, WI 54401-8003  
PH. 715-675-3311

DATA VOLTS: 460

**CERTIFICATION DATA SHEET**

CUSTOMER: \_\_\_\_\_ CUSTOMER P.O. #: \_\_\_\_\_  
 ORDER #: \_\_\_\_\_ REFERENCE MODEL #: 56T34F99031  
 CONN. DIAGRAM: EE7308 CAT #: KG236A  
 OUTLINE: A-100352-806 CUSTOMER PART #: \_\_\_\_\_  
 WINDING: ZT2141 R1 1 MOUNTING: F1 ONLY  
 SPEED: \_\_\_\_\_

**TYPICAL MOTOR PERFORMANCE DATA**

HP	KW	SYNC RPM	FL RPM	FRAME	ENCLOSURE	TYPE	KVA CODE	DESIGN	
1.5	1.1	3600	3515	56J	TEFC	TFR	M	B	
PH	HZ	VOLTS	AMPS	START TYPE	DUTY	INSL	S.F.	AMB	ELEV.
3	60/50	230/460#190/380	4/2&3.4/1.7	ACROSS-THE LINE	CONT	B	1.15	40	3300
	F.L. EFF	84.0	3/4 LD EFF	84.8	1/2 LD EFF	82.3	GTD EFF		ELECT. TYPE
	F.L. PF	83.5	3/4 LD PF	77.8	1/2 LD PF	67.2	82.5		SQ CAGE IND RUN
F.L. TORQUE	LR AMPS @ 460 V	L.R. TORQUE	B.D. TORQUE	F.L. RISE (°C)					
2.20 LB-FT	19.4	7.3 LB-FT	332%	9.6 LB-FT	436%	38			
@ 3 FT. DBA	POWER	ROTOR WK <sup>2</sup>	MAX. LOAD WK <sup>2</sup>	SAFE STALL TIME	START/SHOUR	MOTOR WGT			
69 DBA	78 DBA	0.05 LB-FT <sup>2</sup>	3 LB-FT <sup>2</sup>	20 SEC.	2	55 LB.			

**\*\*\* SUPPLEMENTAL INFORMATION \*\*\***

DE BRACKET TYPE	ODE BRACKET TYPE	MOUNT TYPE	MOTOR ORIENTATION	SEVERE DUTY	HAZARDOUS LOCATION	DRIP COVER	SCREENS	PAINT
C-FACE	STANDARD	ROUND	HORIZONTAL	NO	NONE	NO	NONE	GRAY (POWDER)
BEARINGS	GREASE	SHAFT TYPE	SPECIAL DE	SPECIAL ODE	SHAFT MATERIAL	FRAME MATERIAL		
DE ODE	BALL	POLYREX EM	JET PUMP	NONE	416 STAINLESS (C-509)	ROLLED STEEL		
6205	6203							
THERMOSTATS	PROTECTORS	WDG RTD's	BRG RTD's	THERMISTORS	CONTROL	SPACE HEATERS		
NONE	NOT	NONE	NONE	NONE	FALSE	NA		
R1 (ohms/ph)	R2 (ohms/ph)	X1 (ohms/ph)	X2 (ohms/ph)	Xm (ohms/ph)	VIBRATION (in/sec)	FLOAT		
1.419	0.946	2.318	2.129	79.937	0.150	ODE		

* N	INVERTER TORQUE:	NONE
O	INV. HP SPEED RANGE:	NONE
T	ENCODER:	NONE
E		NONE
S		NONE
*		NONE

PREPARED BY: FAREEDA DUDEKULA  
 DATE: 9/17/2018  
 UL: V-INS, CONST UL REC  
 HZ:

Data Sheet

Date: 9/17/2018

56734F99031

Customer: \_\_\_\_\_  
Attention: \_\_\_\_\_



Submital

Submitted by: FAREEDA DUDEKULA

Data @ 460 V

Motor Load Data

Load	0%	25%	50%	75%	100%	115%	125%	LR
Current (Amps)	0.90	1.00	1.30	1.60	2.00	2.40	2.40	19.4
Torque (ft-lb)	0.00	0.60	1.10	1.70	2.20	2.80	2.80	7.3
RPM	3600	3575	3555	3535	3515	3,500	3485	0
Efficiency (%)		73.4	82.3	84.8	84.0	84.0	84.0	
P.F. (%)	17.0	47.5	67.2	77.8	83.5	85.1	86.8	58.0

Motor Speed Data

	LR	Pull-Up	BD	Rated	Idle
Speed (RPM)	0	650	2815	3515	3600
Current (Amps)	19.4	18.6	12.1	2.00	0.90
Torque (ft-lb)	7.3	6.1	9.6	2.20	0.00

Information Block

HP	1.5				
Sync. RPM	3600				
Frame	143182TFC6080				
Enclosure	TEFC				
Construction	TFR				
Voltage	230/460#190/380 V				
Frequency	60 Hz				
Design	A				
LR Code letter	M				
Service Factor	1.15				
Temp Rise @ FL	38 °C				
Duty	CONT				
Ambient	40 °C				
Elevation	1,000 feet				
Motor/Shaft wk <sup>2</sup>	0.05 Lb-Ft <sup>2</sup>				
Ret Wdg	ZT2141 R1				
Sound Pressure @ 1M	69 dBA				
VFD Rating	NONE				
Outline Dwg	A-100352-906				
Conn. Diag	EE7308				
Additional Specifications:					
0					
0					
	EQUIV CKT (OHMS / PHASE)				
	R1	R2	X1	X2	Xm
	1.4190	0.9460	2.3180	2.1290	79.9370

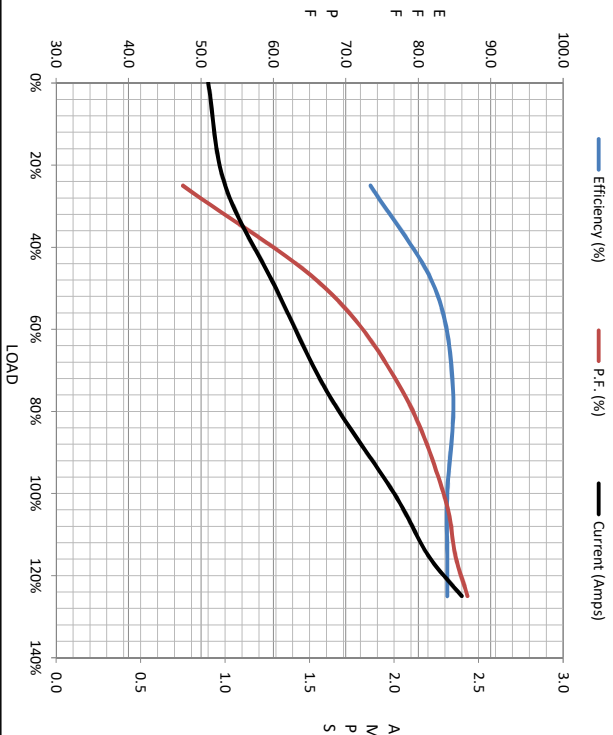

Speed - Torque Curve

